

Bohrer Spezifikation: L/D = 2

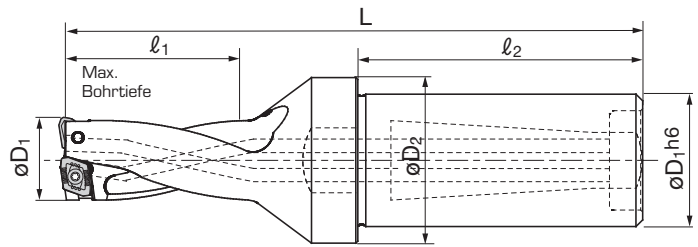

Hinweis
Der neue TDX-Bohrer weist im Vergleich zum vorherigen TDX-Bohrer eine abweichende Bohrergesamtlänge auf.

Bohrer øD (mm)	Artikel Nr.	Lager	Abmessungen (mm)					Max. Mitten- versatz + (mm)	Wende- schneidplatten	Spannschraube	Schlüssel						
			øD ₁	øD ₂	l ₁	l ₂	L										
12.5	TDX125W20-2	●	20	25	25	43	87.5	0.8	XPMT040104R-DC	CSTB-2	T-6D						
13.0	TDX130W20-2	●			26		89.0	0.7									
13.5	TDX135W20-2	●			27		90.5	0.5									
14.0	TDX140W20-2	●			28		92.0	0.4									
14.5	TDX145W20-2	●			29		93.5	0.3									
15.0	TDX150W20-2	●			30		95.0	0.9									
15.5	TDX155W20-2	●			31		96.5	0.8									
16.0	TDX160W20-2	●			32		98.0	0.6									
16.5	TDX165W20-2	●			33		99.5	0.5									
17.0	TDX170W20-2	●			34		101.0	0.4									
17.5	TDX175W25-2	●	25	32	35	50	109.5	1.2	XPMT06X308R-DC	CSTB-2.2R	T-7D						
18.0	TDX180W25-2	●			36		111.0	1.1									
18.5	TDX185W25-2	●			37		112.5	0.9									
19.0	TDX190W25-2	●			38		114.0	0.8									
19.5	TDX195W25-2	●			39		115.5	0.7									
20.0	TDX200W25-2	●			40		117.0	0.5									
20.5	TDX205W25-2	●			41		118.5	0.4									
21.0	TDX210W25-2	●			42		120.0	0.3									
21.5	TDX215W25-2	●			43		121.5	0.2									
22.0	TDX220W25-2	●			44		123.0	1.2									
22.5	TDX225W25-2	●	32	40	45	55	124.5	1.1	XPMT07H308R-DC	CSTB-2.5	T-8D						
23.0	TDX230W25-2	●			46		126.0	0.9									
23.5	TDX235W25-2	●			47		127.5	0.8									
24.0	TDX240W25-2	●			48		129.0	0.7									
24.5	TDX245W25-2	●			49		130.5	0.5									
25.0	TDX250W25-2	●			50		132.0	0.4									
25.5	TDX255W25-2	●			51		133.5	0.3									
26.0	TDX260W25-2	●			52		135.0	0.2									
27.0	TDX270W32-2	●			32		40	54				65	143.0	1.5	XPMT08T308R-DC	CSTB-3	T-9D
28.0	TDX280W32-2	●						56					146.0	1.2			
29.0	TDX290W32-2	●	58	149.0		1.0											
30.0	TDX300W32-2	●	60	152.0		0.7											
31.0	TDX310W32-2	●	62	155.0		0.4											
32.0	TDX320W32-2	●	64	158.0		0.2											
33.0	TDX330W40-2	●	40	50		66		65	171.0	2.3	XPMT110412R-DC		CSTB-4	T-15D			
34.0	TDX340W40-2	●				68			174.0	2.1							
35.0	TDX350W40-2	●				70			177.0	1.8							
36.0	TDX360W40-2	●				72			180.0	1.5							
37.0	TDX370W40-2	●			74	183.0	1.3										
38.0	TDX380W40-2	●			76	186.0	1.0										
39.0	TDX390W40-2	●			78	189.0	0.7										
40.0	TDX400W40-2	●			80	192.0	0.5										
41.0	TDX410W40-2	●			82	195.0	0.2										
42.0	TDX420W40-2	●			40	55	84		65	198.0		3.1			XPMT150512R-DC	CSTB-5	T-20D
43.0	TDX430W40-2	●	86	201.0			2.9										
44.0	TDX440W40-2	●	88	204.0			2.6										
45.0	TDX450W40-2	●	90	207.0			2.3										
46.0	TDX460W40-2	●	92	210.0			2.1										
47.0	TDX470W40-2	●	94	213.0			1.8										
48.0	TDX480W40-2	●	96	216.0			1.5										
49.0	TDX490W40-2	●	98	219.0			1.3										
50.0	TDX500W40-2	●	100	222.0			1.0										
51.0	TDX510W40-2	●	102	225.0			0.7										
52.0	TDX520W40-2	●	104	228.0	0.5												
53.0	TDX530W40-2	●	106	231.0	-												
54.0	TDX540W40-2	●	108	234.0	-												

● Lagerstandard

Bohrer Spezifikation: L/D = 3

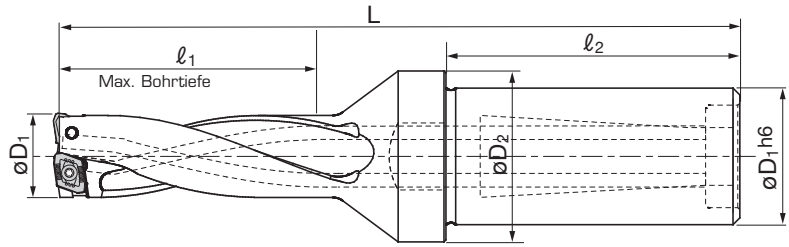

Hinweis

Der neue TDX-Bohrer weist im Vergleich zum vorherigen TDX-Bohrer eine abweichende Bohrgesamtlänge auf.

Bohrer øD (mm)	Artikel Nr.	Lager	Abmessungen (mm)					Max. Mitten- versatz + (mm)	Wende- schneidplatten	Spannschraube	Schlüssel
			øD ₁	øD ₂	l ₁	l ₂	L				
12.5	TDX125W20-3	●	20	25	37.5	43	100	0.8	XPMT040104R-DC	CSTB-2	T-6D
13.0	TDX130W20-3	●			39		102	0.7			
13.5	TDX135W20-3	●			40.5		104	0.5			
14.0	TDX140W20-3	●			42		106	0.4			
14.5	TDX145W20-3	●			43.5		108	0.3			
15.0	TDX150W20-3	●			45		110	0.9			
15.5	TDX155W20-3	●			46.5		112	0.8			
16.0	TDX160W20-3	●			48		114	0.6			
16.5	TDX165W20-3	●			49.5		116	0.5			
17.0	TDX170W20-3	●			51		118	0.4			
17.5	TDX175W25-3	●	25	32	52.5	50	127	1.2	XPMT06X308R-DC	CSTB-2.2R	T-7D
18.0	TDX180W25-3	●			54		129	1.1			
18.5	TDX185W25-3	●			55.5		131	0.9			
19.0	TDX190W25-3	●			57		133	0.8			
19.5	TDX195W25-3	●			58.5		135	0.7			
20.0	TDX200W25-3	●			60		137	0.5			
20.5	TDX205W25-3	●			61.5		139	0.4			
21.0	TDX210W25-3	●			63		141	0.3			
21.5	TDX215W25-3	●			64.5		143	0.2			
22.0	TDX220W25-3	●			66		145	1.2			
22.5	TDX225W25-3	●	67.5	147	1.1						
23.0	TDX230W25-3	●	69	149	0.9						
23.5	TDX235W25-3	●	70.5	151	0.8						
24.0	TDX240W25-3	●	72	153	0.7						
24.5	TDX245W25-3	●	73.5	155	0.5						
25.0	TDX250W25-3	●	75	157	0.4						
25.5	TDX255W25-3	●	76.5	159	0.3						
26.0	TDX260W25-3	●	78	161	0.2						
27.0	TDX270W32-3	●	32	40	81	55	170	1.5	XPMT08T308R-DC	CSTB-3	T-9D
28.0	TDX280W32-3	●			84		174	1.2			
29.0	TDX290W32-3	●			87		178	1.0			
30.0	TDX300W32-3	●			90		182	0.7			
31.0	TDX310W32-3	●			93		186	0.4			
32.0	TDX320W32-3	●			96		190	0.2			
33.0	TDX330W40-3	●	40	50	99	65	204	2.3	XPMT110412R-DC	CSTB-4	T-15D
34.0	TDX340W40-3	●			102		208	2.1			
35.0	TDX350W40-3	●			105		212	1.8			
36.0	TDX360W40-3	●			108		216	1.5			
37.0	TDX370W40-3	●			111		220	1.3			
38.0	TDX380W40-3	●			114		224	1.0			
39.0	TDX390W40-3	●			117		228	0.7			
40.0	TDX400W40-3	●			120		232	0.5			
41.0	TDX410W40-3	●			123		236	0.2			
42.0	TDX420W40-3	●			126		240	3.1			
43.0	TDX430W40-3	●	129	244	2.9						
44.0	TDX440W40-3	●	132	248	2.6						
45.0	TDX450W40-3	●	135	252	2.3						
46.0	TDX460W40-3	●	138	256	2.1						
47.0	TDX470W40-3	●	141	260	1.8						
48.0	TDX480W40-3	●	144	264	1.5						
49.0	TDX490W40-3	●	147	268	1.3						
50.0	TDX500W40-3	●	150	272	1.0						
51.0	TDX510W40-3	●	153	276	0.7						
52.0	TDX520W40-3	●	156	280	0.5						
53.0	TDX530W40-3	●	159	284	-						
54.0	TDX540W40-3	●	162	288	-						

Bohrer Spezifikation: L/D = 4

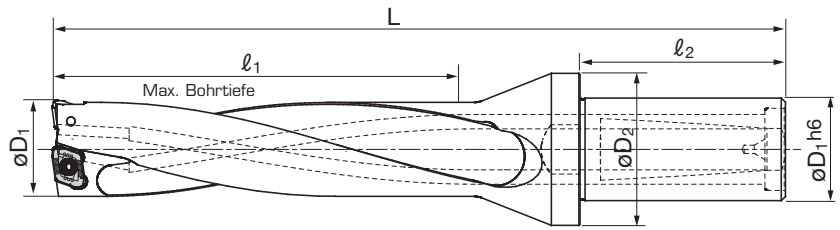

Hinweis
Der neue TDX-Bohrer weist im Vergleich zum vorherigen TDX-Bohrer eine abweichende Bohrergeresamtlänge auf.

Bohrer øD (mm)	Artikel Nr.	Lager	Abmessungen (mm)					Max. Mitten- versatz + (mm)	Wende- schneidplatten	Spannschraube	Schlüssel								
			øD ₁	øD ₂	l ₁	l ₂	L												
12.5	TDX125W20-4	●	20	25	43	50	116	0.8	XPMT040104R-D□	CSTB-2	T-6D								
13.0	TDX130W20-4	●				52						118	0.7						
13.5	TDX135W20-4	●				54						121	0.5						
14.0	TDX140W20-4	●				56						123	0.4						
14.5	TDX145W20-4	●				58						125	0.3						
15.0	TDX150W20-4	●				60						128	0.9						
15.5	TDX155W20-4	●				62						130	0.8						
16.0	TDX160W20-4	●				64						132	0.6						
16.5	TDX165W20-4	●				66						135	0.5						
17.0	TDX170W20-4	●				68						137	0.4						
17.5	TDX175W25-4	●	25	32	50	70	148	1.2	XPMT06X308R-D□	CSTB-2.2R	T-7D								
18.0	TDX180W25-4	●				72						150	1.1						
18.5	TDX185W25-4	●				74						152	0.9						
19.0	TDX190W25-4	●				76						154	0.8						
19.5	TDX195W25-4	●				78						157	0.7						
20.0	TDX200W25-4	●				80						160	0.5						
20.5	TDX205W25-4	●				82						162	0.4						
21.0	TDX210W25-4	●				84						164	0.3						
21.5	TDX215W25-4	●				86						166	0.2						
22.0	TDX220W25-4	●				88						169	1.2						
22.5	TDX225W25-4	●	37	50	50	90	171	1.1	XPMT07H308R-D□	CSTB-2.5	T-8D								
23.0	TDX230W25-4	●				92						173	0.9						
23.5	TDX235W25-4	●				94						175	0.8						
24.0	TDX240W25-4	●				96						178	0.7						
24.5	TDX245W25-4	●				98						181	0.5						
25.0	TDX250W25-4	●				100						183	0.4						
25.5	TDX255W25-4	●				102						185	0.3						
26.0	TDX260W25-4	●				104						187	0.2						
27.0	TDX270W32-4	●				32						40	55	108	198	1.5	XPMT08T308R-D□	CSTB-3	T-9D
28.0	TDX280W32-4	●												112					
29.0	TDX290W32-4	●	116	208	1.0														
30.0	TDX300W32-4	●	120	213	0.7														
31.0	TDX310W32-4	●	124	217	0.4														
32.0	TDX320W32-4	●	128	222	0.2														
33.0	TDX330W40-4	●	40	50	65	132	238	2.3	XPMT110412R-D□	CSTB-4	T-15D								
34.0	TDX340W40-4	●				136						243	2.1						
35.0	TDX350W40-4	●				140						248	1.8						
36.0	TDX360W40-4	●				144						252	1.5						
37.0	TDX370W40-4	●				148						258	1.3						
38.0	TDX380W40-4	●				152						262	1.0						
39.0	TDX390W40-4	●				156						267	0.7						
40.0	TDX400W40-4	●				160						272	0.5						
41.0	TDX410W40-4	●				164						277	0.2						
42.0	TDX420W40-4	●				55						65	65	168	282	3.1	XPMT150512R-D□	CSTB-5	T-20D
43.0	TDX430W40-4	●	172	287	2.9														
44.0	TDX440W40-4	●	176	292	2.6														
45.0	TDX450W40-4	●	180	296	2.3														
46.0	TDX460W40-4	●	184	302	2.1														
47.0	TDX470W40-4	●	188	306	1.8														
48.0	TDX480W40-4	●	192	311	1.5														
49.0	TDX490W40-4	●	196	316	1.3														
50.0	TDX500W40-4	●	200	320	1.0														
51.0	TDX510W40-4	●	204	325	0.7														
52.0	TDX520W40-4	●	208	330	0.5														
53.0	TDX530W40-4	●	212	335	-														
54.0	TDX540W40-4	●	216	339	-														

● Lagerstandard

Bohrer Spezifikation: L/D = 5

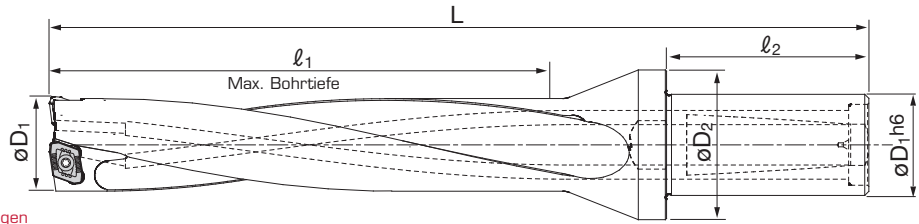

Hinweis
Der neue TDX-Bohrer weist im Vergleich zum vorherigen TDX-Bohrer eine abweichende Bohrgesamtlänge auf.

Bohrer øD (mm)	Artikel Nr.	Lager	Abmessungen (mm)					Max. Mitten- versatz + (mm)	Wende- schneidplatten	Spannschraube	Schlüssel										
			øD ₁	øD ₂	l ₁	l ₂	L														
12.5	TDX125W20-5	●	20	25	62.5	43	128	0.8	XPMT040104R-D□	CSTB-2	T-6D										
13.0	TDX130W20-5	●			65.0							131	0.7								
13.5	TDX135W20-5	●			67.5							134	0.5								
14.0	TDX140W20-5	●			70.0							137	0.4								
14.5	TDX145W20-5	●			72.5							140	0.3								
15.0	TDX150W20-5	●			75.0							143	0.9								
15.5	TDX155W20-5	●			77.5							146	0.8								
16.0	TDX160W20-5	●			80.0							148	0.6								
16.5	TDX165W20-5	●			82.5							152	0.5								
17.0	TDX170W20-5	●			85.0							154	0.4								
17.5	TDX175W25-5	●	25	32	87.5	50	165	1.2	XPMT06X308R-D□	CSTB-2.2R	T-7D										
18.0	TDX180W25-5	●			90.0							168	1.1								
18.5	TDX185W25-5	●			92.5							171	0.9								
19.0	TDX190W25-5	●			95.0							173	0.8								
19.5	TDX195W25-5	●			97.5							176	0.7								
20.0	TDX200W25-5	●			100.0							180	0.5								
20.5	TDX205W25-5	●			102.5							182	0.4								
21.0	TDX210W25-5	●			105.0							185	0.3								
21.5	TDX215W25-5	●			107.5							188	0.2								
22.0	TDX220W25-5	●			110.0							191	1.2								
22.5	TDX225W25-5	●	112.5	193	1.1																
23.0	TDX230W25-5	●	115.0	196	0.9																
23.5	TDX235W25-5	●	117.5	199	0.8																
24.0	TDX240W25-5	●	37	120.0	202	207	0.7	XPMT07H308R-D□	CSTB-2.5	T-8D											
24.5	TDX245W25-5	●									122.5	205	0.5								
25.0	TDX250W25-5	●									125.0	208	0.4								
25.5	TDX255W25-5	●									127.5	211	0.3								
26.0	TDX260W25-5	●									130	213	0.2								
27.0	TDX270W32-5	●									32	40	135	55	225	1.5	XPMT08T308R-D□	CSTB-3	T-9D		
28.0	TDX280W32-5	●											140							231	1.2
29.0	TDX290W32-5	●											145							237	1.0
30.0	TDX300W32-5	●											150							243	0.7
31.0	TDX310W32-5	●											155							248	0.4
32.0	TDX320W32-5	●	160	254	0.2																
33.0	TDX330W40-5	●	40	50	165	65	271	2.3	XPMT110412R-D□	CSTB-4			T-15D								
34.0	TDX340W40-5	●			170															277	2.1
35.0	TDX350W40-5	●			175															283	1.8
36.0	TDX360W40-5	●			180															288	1.5
37.0	TDX370W40-5	●			185						295	1.3									
38.0	TDX380W40-5	●			190						300	1.0									
39.0	TDX390W40-5	●			195						306	0.7									
40.0	TDX400W40-5	●			200						312	0.5									
41.0	TDX410W40-5	●			205						318	0.2									
42.0	TDX420W40-5	●			210						324	3.1									
43.0	TDX430W40-5	●	55	215	330	2.9	XPMT150512R-D□	CSTB-5	T-20D												
44.0	TDX440W40-5	●								220	336	2.6									
45.0	TDX450W40-5	●								225	341	2.3									
46.0	TDX460W40-5	●								230	348	2.1									
47.0	TDX470W40-5	●								235	353	1.8									
48.0	TDX480W40-5	●								240	359	1.5									
49.0	TDX490W40-5	●								245	365	1.3									
50.0	TDX500W40-5	●								250	370	1.0									
51.0	TDX510W40-5	●								255	376	0.7									
52.0	TDX520W40-5	●								260	382	0.5									
53.0	TDX530W40-5	●	265	388	-																
54.0	TDX540W40-5	●	270	393	-																

● Lagerstandard